



***Please read safety instructions before starting. Always have a qualified electrician install kits.**

STEP 1: Turn off power and remove the lamps and ballast cover. Disconnect the incoming power from the ballast, trim the tombstone wires, and remove the ballast if desired or required by law.



STEP 2: Select your wattage on the driver DIP switch. See detailed instruction on back of sheet on how to select and change your wattage. Default wattage is set as per kit part number.



STEP 3: Place the Magnilumen Plus magnetic driver into the fixture, and ground driver. Where required, driver and boards should be permanently affixed to the fixture with self-tapping screws provided.



STEP 4: Connect the new driver to the incoming power.



STEP 5: Apply the retrofit sticker.



STEP 6: Select your color temperature on the magnetized switch on harness (retail packs only). See color kelvin temperature suggestion chart in kit. Place magnetized switch into the fixture.



STEP 7: Magnets are built-in for easy installation. Magnets holders also slide out. To permanently adhere to the fixture, use self-tapping screws provided.

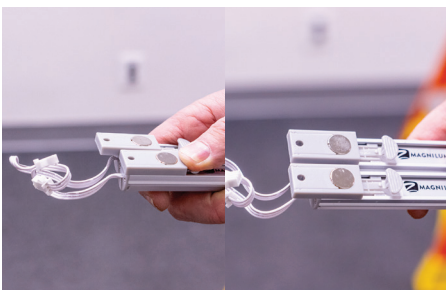

STEP 8: Place the magnetized LED boards into the fixture evenly and align with existing lamp sockets/tombstones. Use self-tapping screws where required. LED bars "Plug and Play" connection whips should face the same direction that the driver harness is coming out of the ballast cover for connection.



STEP 9: Connect wire harness to the "Plug and Play" Magnilumen boards. Replace the ballast cover and connect the wire harness so it is accessible through the end of ballast cover.



*Two bar fixture

*Two bar fixture

STEP 10: Turn on your power to test your newly retrofitted fixture.



STEP 11: Installation is complete. Enjoy!



HOW TO USE THE DIP SWITCH ON DRIVER
EXAMPLE - 20 WATT DRIVER SWITCH SELECTION CHART
NO.1 - NO.3 CHANNEL SWITCH OUTPUT CURRENT

PIN	IRATED	URATED	1	2	3
8W	0190mA	38V	-	-	-
10W	0240mA	38V	ON	-	-
14W	0320mA	38V	-	ON	-
16W	0370mA	38V	-	-	ON
18W	0410mA	38V	ON	-	ON
20W	0470mA	38V	-	ON	ON
22W	0510mA	38V	ON	ON	ON

